

**COLDWELL
BANKER**

COAST PROPERTIES

Amazing!

\$995,000
Price Reduced



Above an ocean cove, firmly set into solid rock plus anchored by a massive 14 ft. fireplace, this spectacular house thrusts a cantilevered flying bridge 25 ft. forward to view amazing, rugged coastline 60 ft. vertically above the water of a small cove. The house matches the drama of the setting facing Southwest; the deck is warm plus windprotected. Inside the two story glass wall reveals the landscape anchored by two stone pillars + the huge fireplace. Amazing!

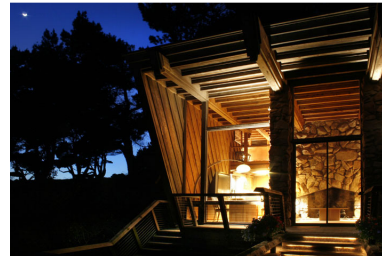

Sold!

*Listed by Coast Properties
Selling price \$925,000*

Two bedrooms
1.5 bathrooms
1,702 square feet
Built 1970
22060 Kelly Court
Timber Cove, CA 95450



Dennis and Kathleen Erba
800.875.2201 x222
707.875.2200 x222
erba@inreach.com
www.ilovebodegabay.com
CA DRE Broker 01290964

www.bodegabayhomes.com

©2010 Coldwell Banker Real Estate Corporation. Coldwell Banker® is a registered trademark licensed to Coldwell Banker Real Estate Corporation. An Equal Opportunity Company. Equal Housing Opportunity. Each Office is Independently Owned and Operated Except Offices Owned and Operated by NRT, Incorporated. Information herein is deemed reliable but not guaranteed. MLS#21009259 9/30/2010

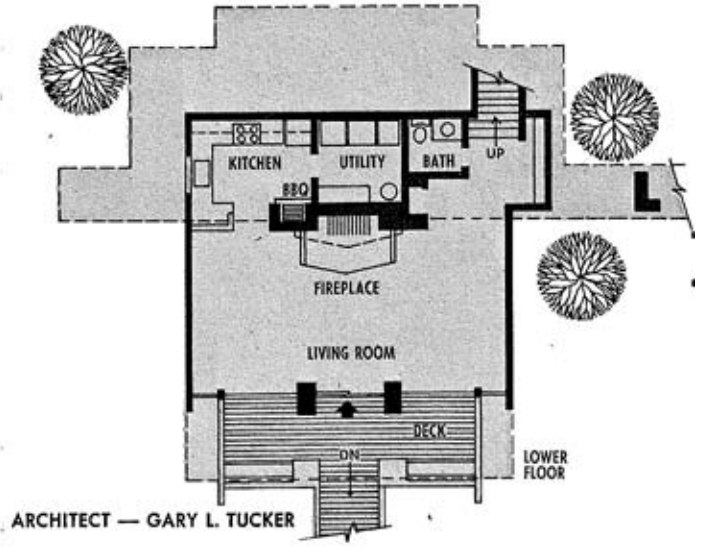

ARCHITECT — GARY L. TUCKER

